

# GN - SNATCH BLOCKS FOR TYPE BL3 SHACKLE LIFTING

Material : Mild steel  
 Safety factor : 4 times  
 Finish : Painted  
 Certificates : Manufacturer Proofload

Sheaves with bronze bearing

Groove size can be changed on request for bigger rope sizes.

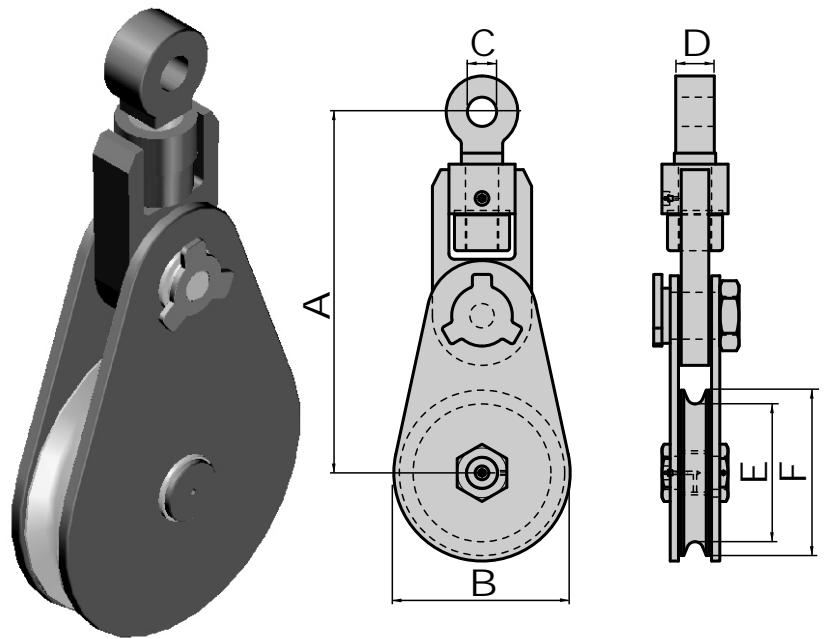

Art No.	Type	SWL Eye pull ton	SWL Line pull ton	Rope Size inch	Rope Size mm	A mm	B mm	C mm	D mm	E mm	F mm	Approx. weight kg
<b>Light Type</b>												
20041903	H41903	3.25	1.62	3/8	8-10	188	82	20	26	56	76	3
20041905	H41905	4.75	2.37	1/2	11-14	250	122	24	30	86	114	8
20041906	H41906	8.5	4.25	3/4	18-20	356	162	30	40	112	152	17
20041908	H41908	8.5	4.25	3/4	18-20	381	216	30	40	163	203	22
20041910	H41910	9.5	4.75	3/4	18-20	406	270	34	44	214	254	28
20041912	H41912	9.5	4.75	3/4	18-20	446	320	34	44	265	305	34
20041914	H41914	12	6	3/4	18-20	516	396	37	48	315	365	43
20041916	H41916	13.5	6.75	7/8	22-25	645	430	42	54	356	406	100
20041918	H41918	17	8.5	1	22-25	690	490	44	57	408	458	120
<b>Heavy Type</b>												
20043106	H43106	17	8.5	1	22-25	490	160	44	57	110	150	49
20043108	H43108	25	12.5	1 1/8	25-28	602	220	53	70	150	200	80
20043110	H43110	25	12.5	1 1/4	28-32	632	270	53	70	190	250	93
20043112	H43112	25	12.5	1 1/4	28-32	662	320	53	70	240	300	109
20043114	H43114	25	12.5	1 1/4	28-32	692	370	53	70	290	350	116
20043118	H43118	35	17.5	1 1/2	32-38	835	470	60	80	380	450	211
20043120	H43120	35	17.5	1 1/2	32-38	865	520	60	80	430	500	238
20043124	H43124	35	17.5	1 1/2	32-38	925	625	60	80	535	605	284
20043224	H43224	55	27.5	1 5/8	38-42	1040	625	73	100	520	605	460
20043230	H43230	85	42.5	1 7/8	44-48	1212	780	85	120	630	750	890
20043234	H43234	120	60	2	50-55	1327	880	100	140	740	860	1200
20043236	H43236	150	75	2 1/2	60-70	1427	930	113	160	760	910	1530
20043242	H43242	200	100	3	75-85	1630	1080	135	170	870	1060	2285
20043246	H43246	250	125	3 1/2	88-93	1785	1190	145	190	970	1170	3015

Tolerance: Forged parts ± 5%, machined parts ± 1 mm

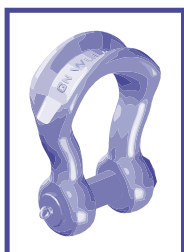

## GN ROPE FITTINGS

Grofsmederij Nieuwkoop B.V. - The Netherlands

www.gnweb.com - sales@gnweb.com

Tel +31(0) 172 579 303, Fax +31(0) 172 571 073

