

J WIDE BODY CHASER

TYPE HK10

Material : Mild steel
Proofload : 1.5 times SWL
Finish : Painted

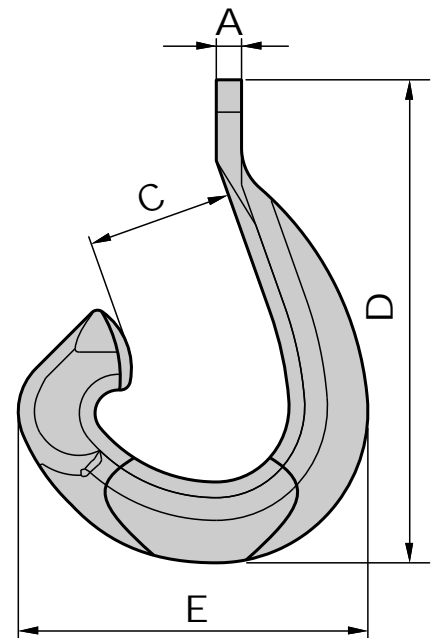
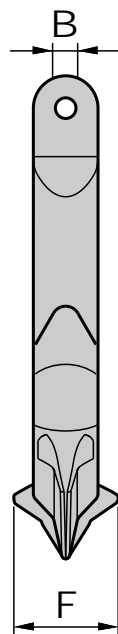

Art. no.	SWL ton	A mm	B mm	C mm	D mm	E mm	F mm	Weight Kg
50001150	150	125	105	680	2220	1780	330	1800
50001200	200	180	150	680	2220	1780	550	2600
50001250	250	180	150	680	2220	1780	600	2730

Tolerance: Forged parts $\pm 5\%$, machined parts ± 1 mm



GN ROPE FITTINGS

Grofsmederij Nieuwkoop B.V. - The Netherlands

www.gnweb.com - sales@gnweb.com

Tel +31(0) 172 579 303, Fax +31(0) 172 571 073

